

## I40 add Gear oil

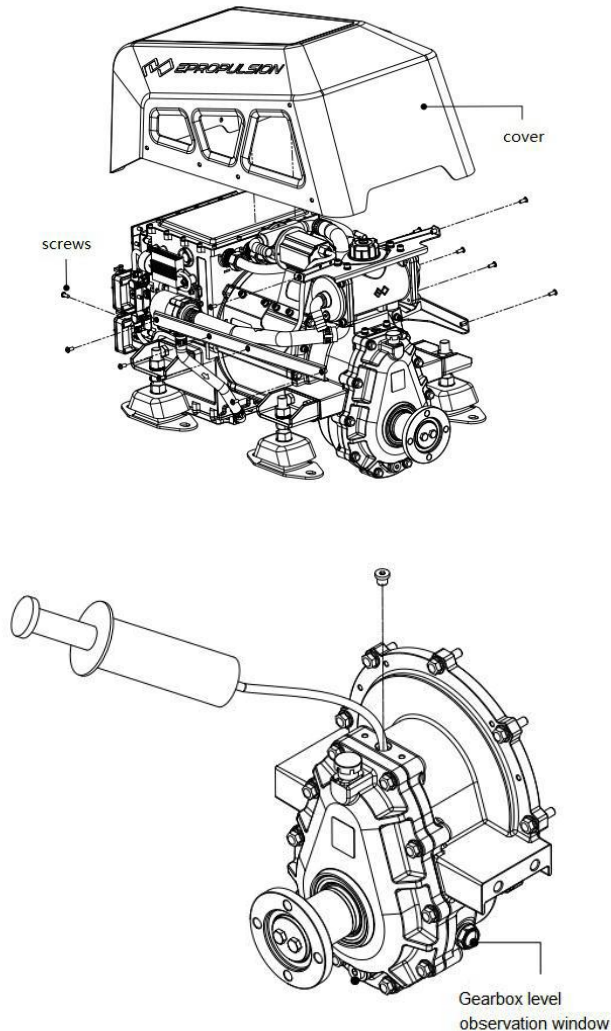

### STEP:

1. Use a 4mm hexagonal wrench to remove 12pcs M5x12 hexagonal screws (5pcs on each side of the cover and 2pcs on the back), and remove the cover.
2. Select a suitable oiling device. It is recommended to use an oiling tube with an outer diameter of less than 8mm. Inject **350ml** of lubricating oil (brand Liqui moly Top Tec ATF 1900) into the gearbox through the oil filling port.
3. After checking that the rubber ring of the oil filling port screw plug is not damaged

(if damaged, the oil filling port screw plug needs to be replaced), install and tighten the oil filling port screw plug.

4. install the cover.